

## PRODUCT INFO

### PRODUCT NAME

Electromagnetic Flow Meter

### PRODUCT CODE

FlowM.260

### PRODUCT CATEGORY

Flowmeter

### PRODUCT PRICE

Talk with a Serrata Instruments Reseller



## APPLICATION GUIDELINES

Electromagnetic flowmeters are ideal for measuring conductive liquids in various industrial and process applications. Our compact stainless steel model is specifically designed for small pipeline installations, ranging from 1/4" to 1 1/2" in diameter. With its built-in display, the device provides real-time flow rate and totalized volume readings, making it a perfect choice for precise flow monitoring. Additionally, it supports multiple output options, including 4-20 mA, Modbus, and Pulse, allowing seamless integration into automation and control systems.



## COMPACT & FULL-FEATURED ELECTROMAGNETIC FLOWMETER FOR SMALL PIPELINES

This flowmeter is suitable for applications where the liquid conductivity is above 20  $\mu\text{S}/\text{cm}$ , ensuring reliable performance in industries such as water treatment, chemical dosing, food and beverage processing, and laboratory environments. Thanks to its robust stainless steel construction, the device offers excellent durability even in demanding conditions. Whether for continuous monitoring or batch processes, this electromagnetic flowmeter provides accurate, maintenance-free operation with no moving parts that could wear out over time.

## CONTACT US

+49 (0) 211 63 55 32 11 [info@serratainstruments.com](mailto:info@serratainstruments.com)  
Düsseldorf, Germany [serratainstruments.com](http://serratainstruments.com)

## KEY FEATURES PRODUCT

### INTEGRATION AVAILABILITY

- 4-20 mA, pulse and Rs485 Modbus outputs

### ROBUST DESIGN

- Robust Stainless Steel Construction

### CHARACTERISTIC FEATURES

- No moving part, integrated LCD, Cumulative results

### APPLICATION USAGE

- Industrial and Water Treatment Applications



INFORMATION	G1/4"	G1/2"	G1"	G1-1/2"
DN value	DN4	DN8	DN15	DN25
Measuring Range	0,1.....10 l/m	0,5.....25 l/m	2.....100 l/m	4.....200 l/m
Accuracy / Repeatability	<0,5 % of Full Range / <0,2 % of Full Range			
Working Temperature	-25.....+120 °C (no thermal shock)			
Ambient Temperature	-25.....+80 °C			
Working Pressure	max 16 Bar			
Response Time	100 ms			
Medium to be measuring	Conductive Liquid (Conductivity should be higher than 20 uS/cm)			
Materials	Electrode and Process Connection : 316T Measuring Tube : Peek    Housing : 304    Seal : EPDM			
Power Supply	24 Vdc (+- %10)    <100 mA consumption			
Display	4 Row LCD; instantaneous flow, unit cumulative flow and its unit.			
Outputs	4-20 mA, Pulse and Rs485 Modbus (M12 8 pins connector)			

### CONTACT US

+49 (0) 211 63 55 32 11  
info@serratainstruments.com

Düsseldorf, Germany  
www.serratainstruments.com

## DIMENSION

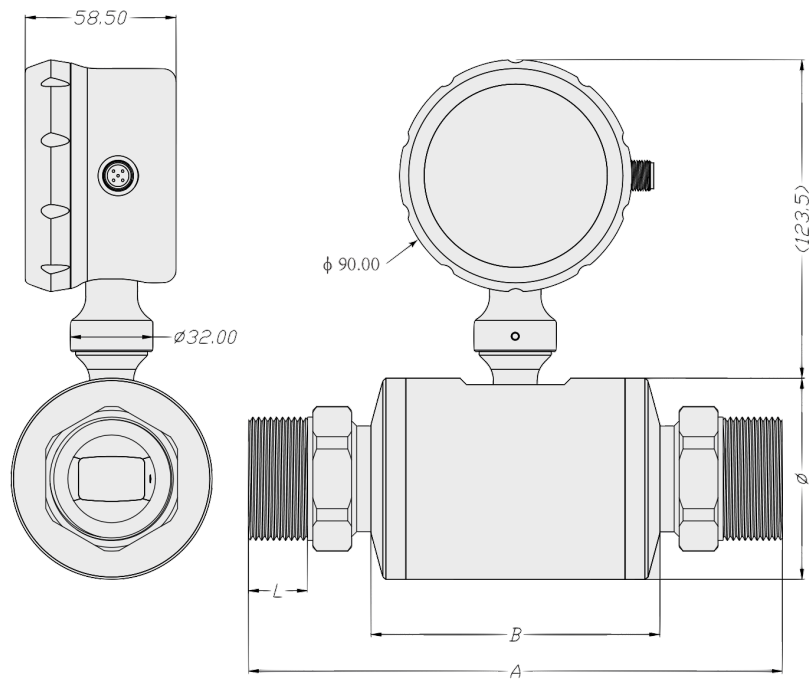

Model	External Thread Connection	Pipe Diameter	A	B	$\phi$	Effective screw (L)	Measuring Range (liter per min)
FlowM.260-GM-04-PR	G1/4"	DN4	110	60	45	12	0,1-10
FlowM.260-GM-08-PR	G1/2"	DN8	141	74	60	18	0,5-25
FlowM.260-GM-15-PR	G1"	DN15	170	90	70	20	2-100
FlowM.260-GM-25-PR	G1-1/2"	DN25	207	112	78	25	4-200

## INSTALLATION PRECAUTIONS

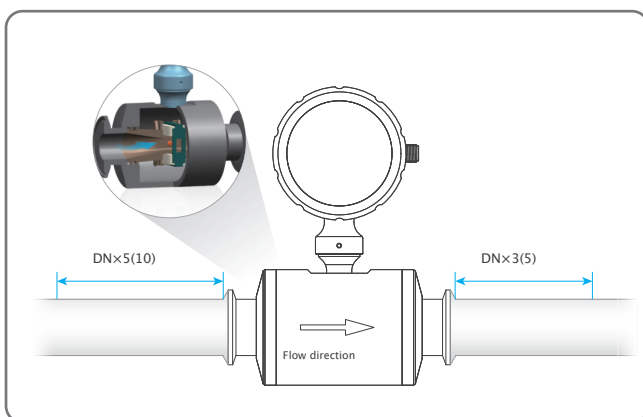

## INDICATOR

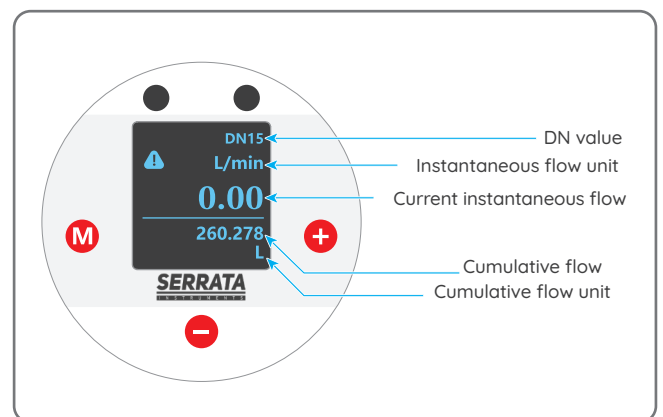

CONTACT US

+49 (0) 211 63 55 32 11  
info@serratainstruments.com

Düsseldorf, Germany  
www.serratainstruments.com